

# Truman St. NE & San Mateo Blvd NE



## PROPERTY DETAILS

### Address:

- 230 Truman St. NE,  
one block west of San Mateo Blvd. NE.

### Size:

- 0.599 acres, consisting of two lots

### Zoning:

- Mixed-Use Transition (MX-T)

### Utilities:

- All utilities (including water, sewer,  
electric) available.

### Improvements:

- 11,000 sq. ft. building, ~40 paved parking  
spaces, and walled in outdoor area

### Located in a MRA?

- Yes, located within the  
Central/Highland/Upper Nob Hill MRA.

# Establishments Near Truman St. NE & San Mateo Blvd NE



# Central/Highland/Upper Nob Hill MRA

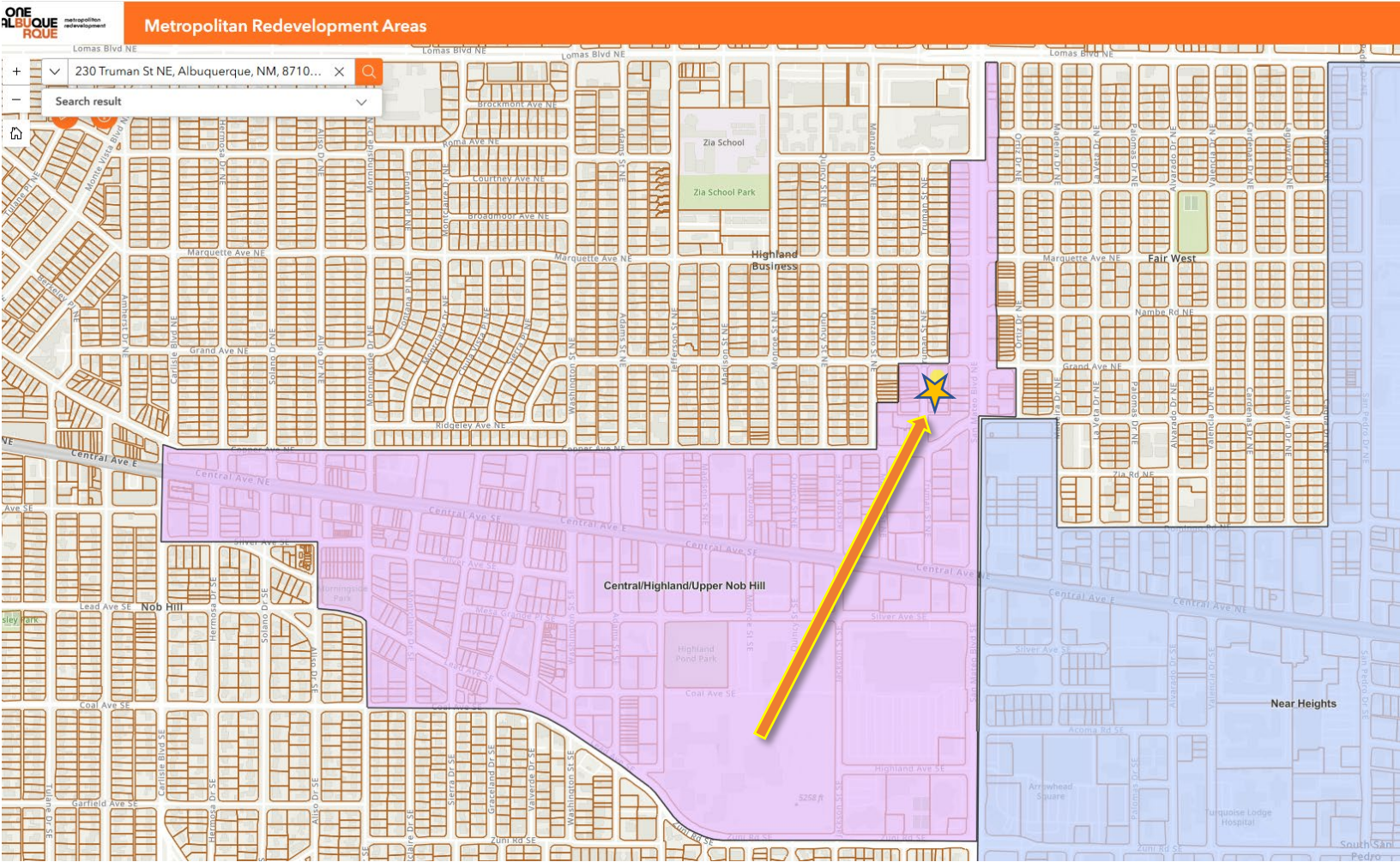

The 230 Truman St. NE property is located within the Central/Highland/Upper Nob Hill Metropolitan Redevelopment Area and is also close to the Near Heights MRA.

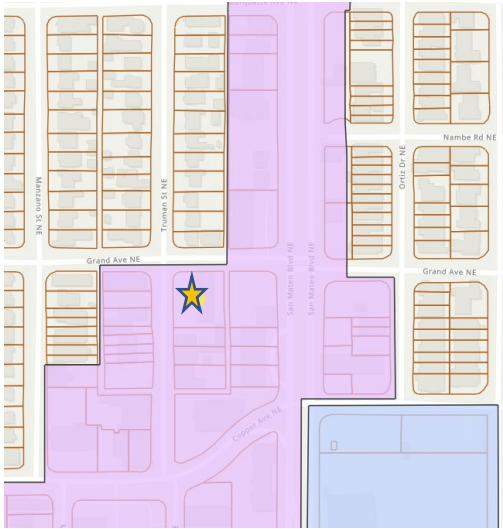

# View from NW Corner of 230 Truman St. NE, looking East



# 230 Truman St. NE – Interior with Fire Suppression & Elevator



# 230 Truman St. NE – Walled In Outdoor Area

