



Stephanie Garcia Richard, Commissioner of Public Lands
State of New Mexico

BACKPACK CAMPING: LUERA MOUNTAINS PERMIT APPLICATION

I. INSTRUCTIONS

To apply for a Backpack Camping Permit please **READ THIS CAREFULLY!**

Complete the application form below. Incomplete applications will be returned. Only holders of a New Mexico Department of Game and Fish (NMDGF) license for hunting within GMU 16 are eligible to apply for a Backpack Camping Permit. Complete applications should be emailed to Huntermppermits@slo.state.nm.us or mailed to the New Mexico State Land Office ATTN: Backpack Camping Application, 310 Old Santa Fe Trail, Santa Fe, New Mexico 87501. If applying via email, please submit application at least ten calendar days in advance of period of use. If applying via U.S. mail, please allow seventeen days.

The policy regulating Luera Mountains Backpack Camping Permit is available online here: https://bit.ly/SLO_Hunt_Info. Check the box below to indicate you have read and agree to abide by the Luera Mountains Backpack Camping Policy.

I have read and will comply with the policy and applicable rules:

II. APPLICANT INFORMATION (ALL FIELDS MUST BE COMPLETED)

NAME (First M. Last): _____

ADDRESS: _____

CITY, STATE, ZIP: _____

CELL PHONE NUMBER: _____

EMAIL ADDRESS: _____

DATE OF BIRTH: _____

DRIVER'S LICENSE NUMBER & STATE OF ISSUANCE: _____

VEHICLE MAKE / MODEL: _____

LICENSE PLATE #: _____

EMERGENCY CONTACT / CELL PHONE NUMBER: _____

**PERMITTEES CAN HAVE UP TO THREE GUESTS TO ASSIST WITH THE HUNT.
LIST GUEST NAMES HERE:**

1. _____

2. _____

3. _____

III. SUPPLEMENTAL INFORMATION

NMDGF HUNTING LICENSE NUMBER:

LICENSED HUNT DATES: _____

CAMP START DATE: _____

CAMP END DATE: _____

(MAXIMUM CAMPING PERIOD IS 14 DAYS)

A Backpack Camping Permit is NOT needed to camp in existing campsites on State Trust Land, including the Luera Campsite within GMU 16. For more information about these campsites, go to <https://bit.ly/SLOHuntMap>.

Approved backpack camping areas are shown on the map provided online along with the application and the Luera Mountains Backpack Camping Policy.

IV. TERMS AND CONDITIONS

Applicant is responsible for compliance with the terms and conditions of this Permit and the current NMDGF Easement. New Mexico State Land Office Hunting Information is found here: https://bit.ly/SLO_Hunt_Info. Applicant understands that approval of this application and issuance of any permit is subject to the discretion of the Commissioner of Public Lands. Applicant has read and will comply with the conditions laid out in the current hunting proclamation related to State Trust Land. Applicant understands that any violation of these terms and conditions may result in the denial of access to State Trust Land and other appropriate legal action. Violations of applicable statutes or rules could also result in referral to NMDGF or the local district attorney for enforcement.

a. A Permit is only valid in the possession of Permittee and shall become invalid if possessed by anyone other than the Permittee.

b. The commission of a prohibited activity by any person who gained access to State Trust Land pursuant to this Permit shall render the Permit cancelled immediately, and shall constitute grounds for the Commissioner to deny access to any such person.

c. It is the Permittee's responsibility to know their location at all times and where permitted activities are allowed and which lands are closed to these activities.

d. If Permittee encounters an unlocked gate, the Permittee must ensure the gate is closed after passing through.

e. Motorized vehicle (and any mechanical form of transportation) access is permitted via public highways and roads only (as defined by Section 67-2-1 NMSA 1978).

f. "Pack it In, Pack it Out" – Permittees must "leave no trace" of their visit to State Trust Land. Trash MUST be packed out and disposed of properly. Permittee will be required to protect State Trust Land from environmental degradation. All trash must be hauled out of State Trust Land, not buried or burned.

g. Properly dispose of human waste.

- Dig a hole (or 'cat hole') 6 to 8 inches deep and at least 300 feet from any water source to bury human waste;
- Remove used toilet paper from State Trust Land; and
- Sanitary portable toilet systems are acceptable provided all waste is removed from the area and disposed of properly.

h. Campfires are prohibited except as currently permitted by the New Mexico State Forester. The Commissioner reserves the right to impose restrictions more limiting, as warranted, than those from the State Forester (e.g., following county mandated restrictions). It is the Permit holder's responsibility to obtain current information and to comply with any restrictions in place. Information is available by accessing www.emnrd.state.nm.us/SFD/Announcements.html or by calling the Fire Restrictions Hotline at 1-877-864-6985.

If campfire restrictions are not in place, Permittees must still take care to prevent forest fires. This includes, but is not limited to:

- a.** never leaving a campfire or other heat source unattended and ensuring campfires are dead out and cold to the touch before leaving the area; and
- b.** maintaining a distance of five feet cleared to bare soil and free of any overhead flammable materials in all directions around the campfire.

Permittee may pack in fire wood for campfires, or may use downed wood. Permittee may not cut standing trees, even if those trees are dead. If Permittee observes a fire that has spread out of control, whether or not Permittee started that fire, Permittee must immediately call 911 and then report the fire to the State Land Office.

i. Permittee will be required to accommodate and avoid interference with the activities of other authorized users of the same State Trust Land. Permittee must be prepared to make the Permit immediately available for inspection by other authorized lessees of State Trust Land, law enforcement officials (including Department of Game and Fish staff), or State Land Office personnel.

j. Permittee understands that this Permit is issued as part of a pilot program. Permittee agrees to complete a brief survey, if asked, after use of the Permit to assist the NMSLO in program assessment.

Permittee agrees that Permittee and those accompanying the Permittee shall not engage in PROHIBITED ACTIVITIES, including, but not limited to, the following:

1. disturbing, dislodging, damaging, destroying or removing native plants, standing timber wood products, flowers, growing crops, or any other plant life other than pinon nuts gathered non-commercially;
2. grazing animals or disturbing, harassing, injuring, or destroying livestock;
3. disturbing, dislodging, damaging, destroying or removing historical, archaeological, paleontological or cultural sites, or artifacts;
4. disturbing, dislodging, defacing, damaging or destroying any improvement, fixture, item, object, or thing placed or located in, under, or upon the land;
5. discarding refuse, waste, or litter of any kind;
6. violating any applicable law, statute, regulation, ordinance, or rule enacted by a governmental entity;
7. mineral exploration, development, or mining, or collecting valuable rocks or minerals;
8. interfering with the authorized activities of other land users;
9. camping within 200 feet of wetlands, including intermittent streams, or camping within 300 feet of historical structures, archaeological resources, or ranching structures, including corrals and stock tanks; or
10. entering, climbing, or accessing in any way structures, buildings, fixtures or improvements other than fences located on State Trust Land.

V. ACKNOWLEDGEMENT

Permittee acknowledges that Permittee and those accompanying the Permittee are aware of the terms and conditions as set forth herein and agree to abide by them. PERMITTEE FURTHER AGREES THAT ENTRY ON STATE TRUST LAND BY PERMITTEE AND THOSE IN THE COMPANY OF PERMITTEE SHALL BE SOLELY AT THE RISK OF PERMITTEE.

Neither the Commissioner nor the Commissioner's other lessees/grantees extend to Permittee any assurance that state lands are safe for access or assume responsibility or liability for any injury or damage to Permittee or those in Permittee's company incurred while on state lands. Permittee agrees to assume all liability for claims, losses or damages alleged to arise out of or indirectly connected with the activities on state lands of Permittee and those in the company of Permittee. Permittee further agrees to save, hold harmless, indemnify and defend from liability for all such claims, losses or damages lessees of state land, Commissioner and Commissioner's agents and employees in their official and individual capacities. Permittee acknowledges that failure to comply with the requirements of this Permit, including but not limited to the restrictions on campfires, may subject Permittee to civil or criminal penalties.

I certify under penalty of law that I have read and understand the information contained in this application, and agree to abide by the terms of the Backpack Camping Policy and all applicable laws and rules.

BY: _____
PERMITTEE

DATE: _____

VI. PERMIT APPROVAL

BY:
STEPHANIE GARCIA RICHARD
COMMISSIONER OF PUBLIC LANDS





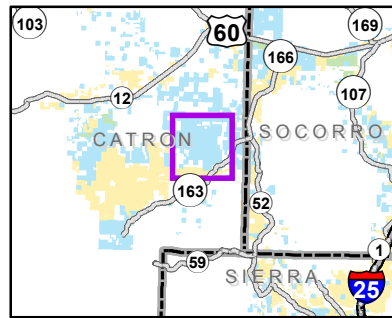
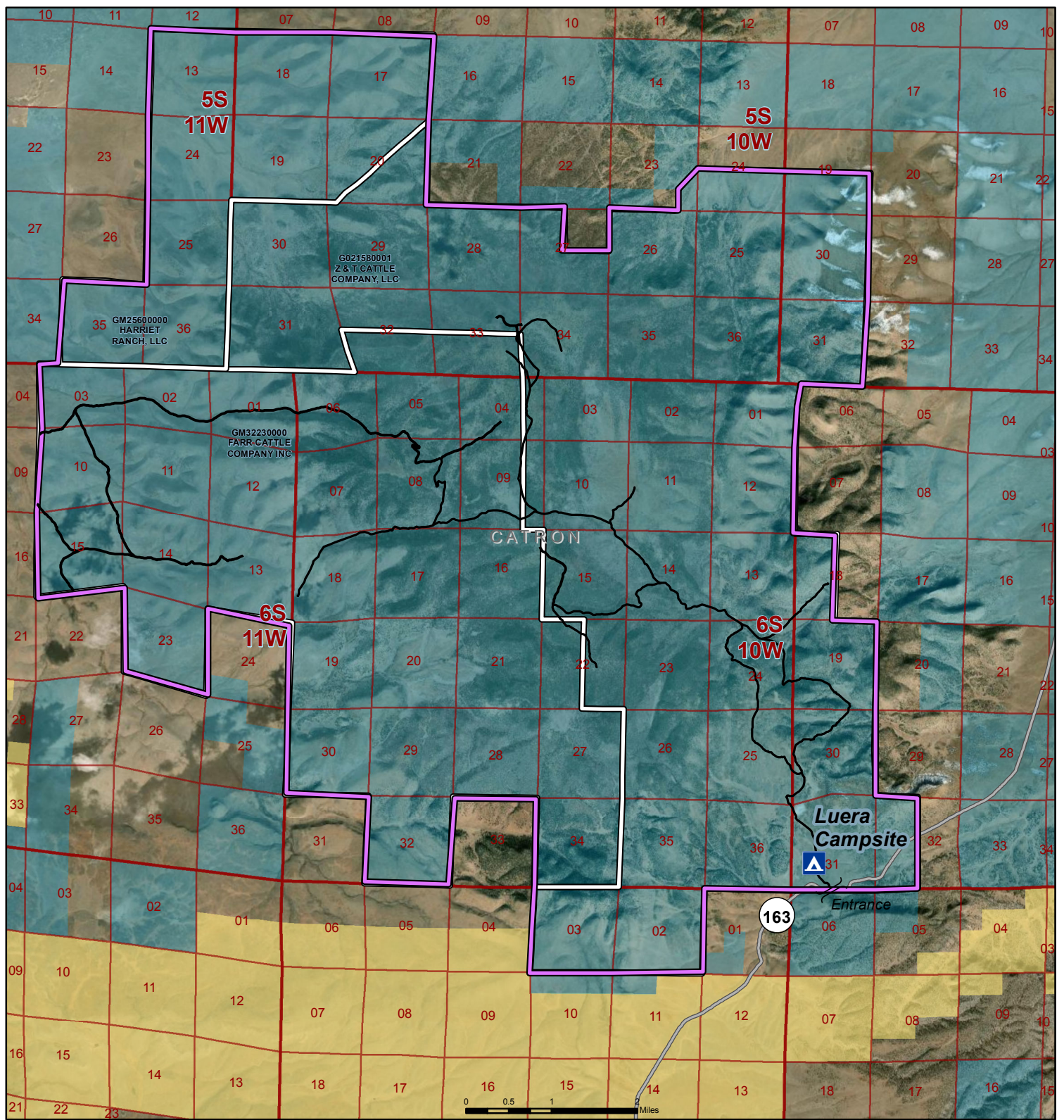

PERMIT EFFECTIVE DATE: _____

PERMIT EXPIRATION DATE: _____

PERMIT NUMBER: _____

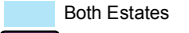

Luera Mountain Backpack Camping Map

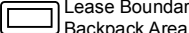
- | | |
|---|--|
|  Existing Campsite | State Trust Lands |
|  Area Roads |  Surface Estate |
|  County Boundaries |  Both Estates |
|  Bureau of Land Management |  Backpack Boundary |
| |  Lease Boundaries within Backpack Area |



Stephanie Garcia Richard
 Commissioner of Public Lands
 505-827-5761
www.nmstatelands.org

The New Mexico State Land Office assumes no responsibility or liability for, or in connection with, the accuracy, reliability or use of the information provided herein, with respect to State Land Office data or data from other sources. Data pertaining to New Mexico State Trust Lands are provisional and subject to revision, and do not constitute an official record of title. Official records may be reviewed at the New Mexico State Land Office in Santa Fe, New Mexico. Compiled, edited and printed by the Land Office Geographic Information Center. V:\Field\GameAndFish\MXDS\NMSLO_CampPilot_2020_Luera. Save Date: July 21, 2020. Created by: Eleanor Nestlerode enestlerode@sls.state.nm.us 505-827-5735